

雪見だいふくパズル Instructions

(How to assemble Yukimi Daifuku A)

If the mark is difficult to see, use a magnifying glass or a smartphone magnifier app.

- 1** ● Each ice cream part has a different mark. Check the marks and corresponding numbers in the right picture.
※ The illustration shows the ice cream part viewed from bottom.

Please cut the parts cleanly with nippers or similar tools. If any bumps remain on the cut surface, it may interfere with playing the puzzle.

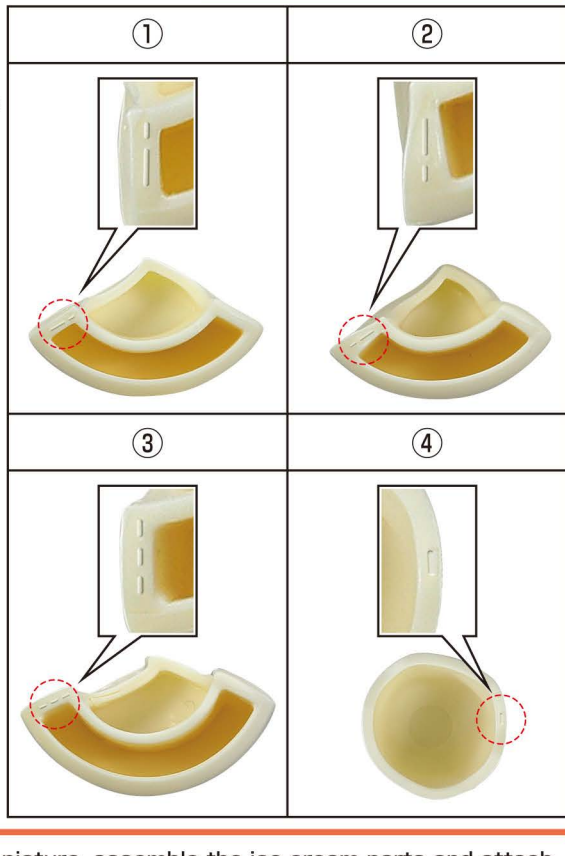

- 2** ● As shown in the picture, assemble the ice cream parts and attach them to the mochi part.

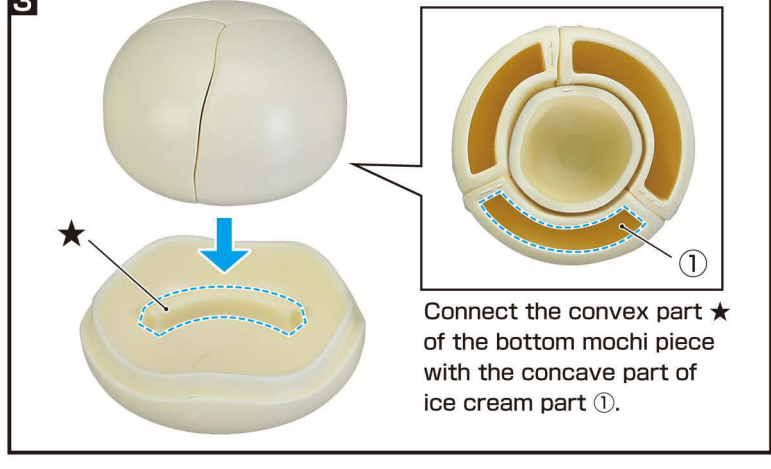
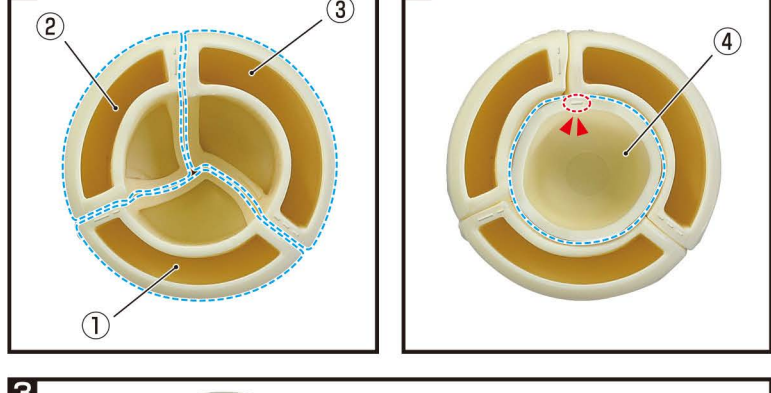

● Yukimi Daifuku A is complete.

Complete!

(How to assemble Yukimi Daifuku B)

If the mark is difficult to see, use a magnifying glass or a smartphone magnifier app.

- 3** ● Each ice cream part has a different mark. Check the marks and corresponding numbers in the right picture.
※ The illustration shows the ice cream part viewed from bottom.

Please cut the parts cleanly with nippers or similar tools. If any bumps remain on the cut surface, it may interfere with playing the puzzle.

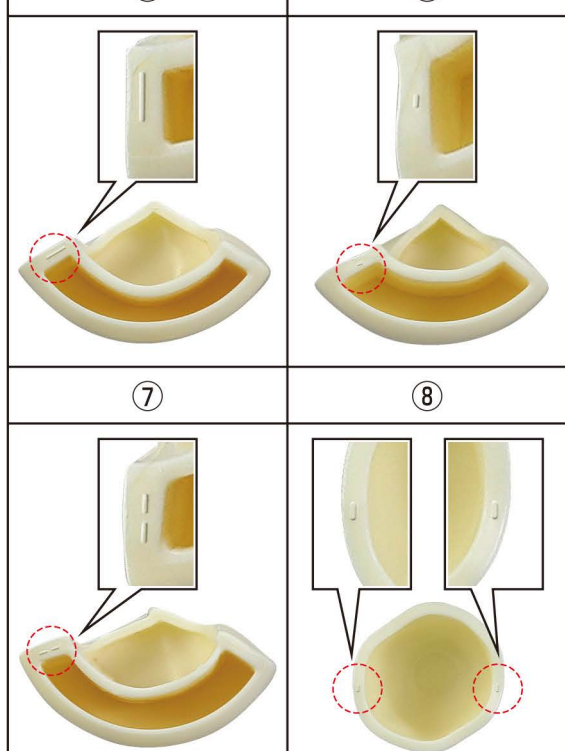

- 4** ● As shown in the picture, assemble the ice cream parts and attach them to the mochi part.

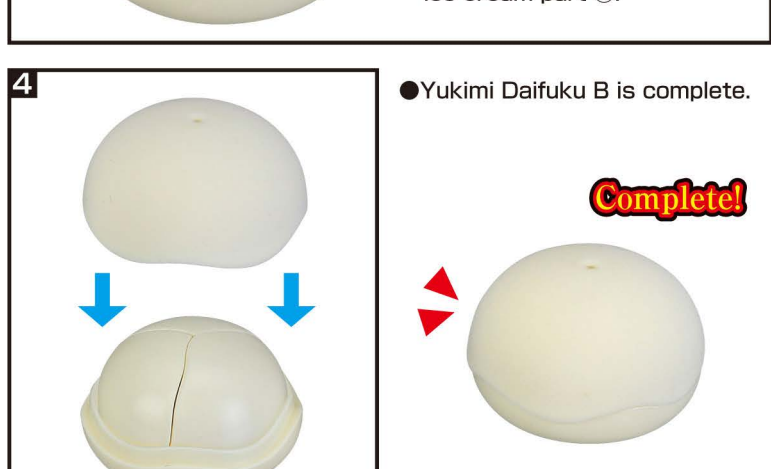
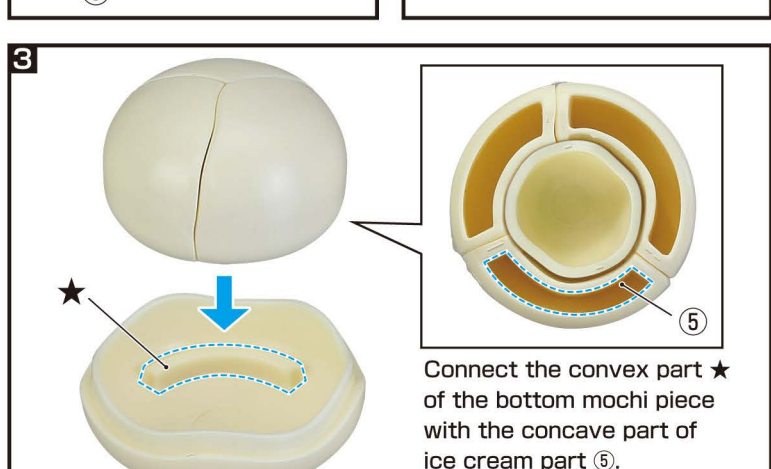
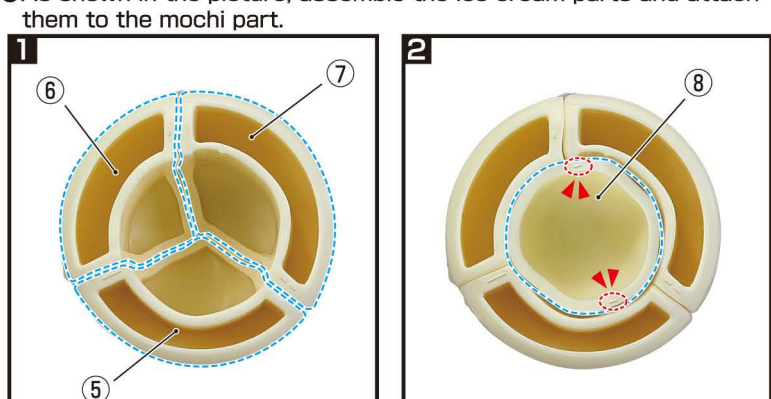

● Yukimi Daifuku B is complete.

Complete!



Once everything fits together perfectly with no gaps, it's complete!

※ Assemble both daifuku pieces.

If there are gaps between the ice cream parts and the mochi parts, please try again.

If the parts do not fit together properly...

- The parts have been assembled incorrectly.
- The batter parts have been assembled incorrectly.
- The shrimp parts and batter parts have been assembled in the wrong orientation.

Please check the above.

If it still doesn't fit perfectly, try again from the beginning.

About the Accessories

- Place the completed Yukimi Daifuku into the container for display.

